

AdjustableSystem™ Components

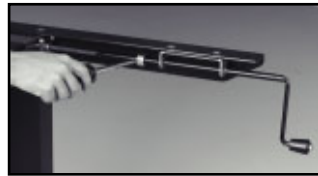

- Pull-out distance of crank is adjustable with of a set-collar

Front Crank Kit

- Can be installed in either left hand or right hand side bases
- Material: Internal components: steel
Shaft: aluminum
Handle: plastic; Color: black

Description	For Top Depths	Item No.
front crank-short	572-813 (22 1/2"-32")	630.00.391
front crank-long	813-914 (32"-36")	630.00.392

Packing: 1 set

Front Crank Option Details:

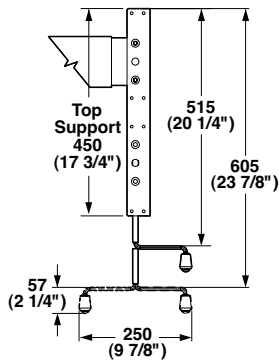

For top depths 572 mm - 597 mm (22 1/2" - 23 1/2") use:
Front crank-short # 630.00.391
Top support-450 # 630.00.351

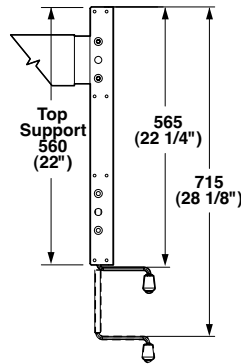

For top depths 597 mm - 813 mm (23 1/2" - 32") use:
Front crank-short # 630.00.391
Top support-560 # 630.00.352

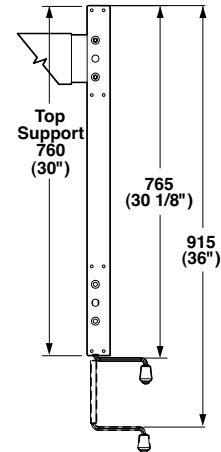

For top depths 813 mm - 914 mm (32" - 36") use:
Front crank-long # 630.00.392
Top support-760 # 630.00.353

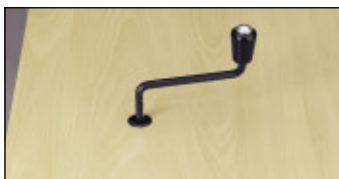

Top Crank Kit

- Includes black plastic trim grommet for desk top and bracket to store crank under top when not in use
 - Can be installed in either left hand or right hand side bases, straight tables only
 - For corner tables, top crank can only be installed in left hand side
- Material: Shaft: steel
Handle and grommet: plastic

Color	Item No.
black	630.00.393

Packing: 1 set

- Plastic trim grommet for desktop requires a \varnothing 20 mm hole

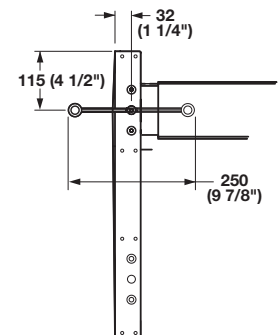
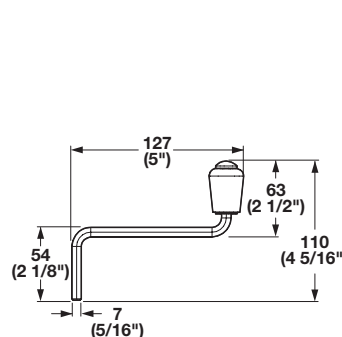
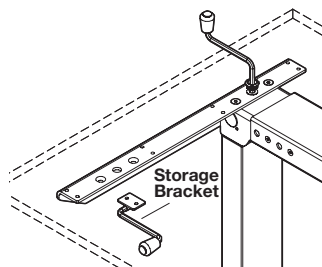
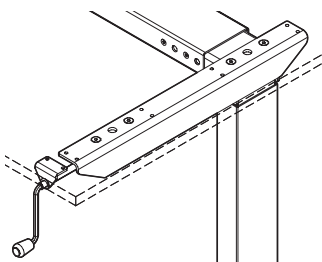

Dimensions in mm
Inches are approximate